

C0404-01

BRACKET FOR DISCONNECT SWITCH DUPLEX AND ARCING HORNS, OFF-SET CROSSWISE, AT THE END OF POLE, TO POLES HEB 180–260

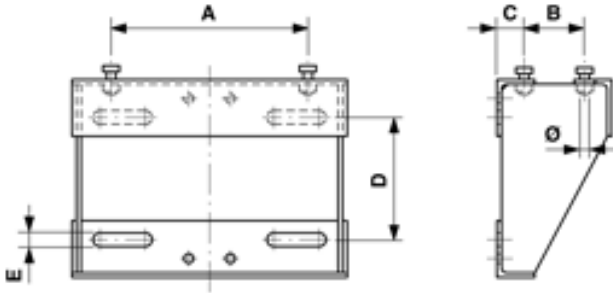

DIMENSIONS

E: 18 mm

Ø: M12

A: 260 mm

B: 80 mm

C: 36 mm

D: 162 mm

MATERIAL AND WEIGHT

Weight: 8.450 kg

Material: STL HDG

COMMENTS

- Attachment material for poles HEB:

U-bolt Ø= 16 mm

Part-no. E0888-... (2 pcs.)

(to be ordered separately)