

C2376-03

LINE INSULATOR KUSYS2 COMPLETE PULL-OFF LEVER ARM SUSPENSION DOUBLE EYE, TO PIPE 2.5"

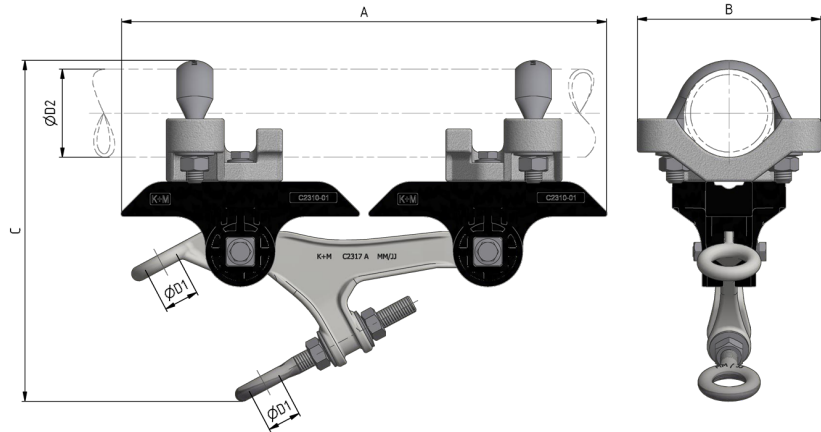

DIMENSIONS

A: 334 mm

B: 126 mm

C: 223 mm

ØD1: 24 mm

ØD2: 2.5" (76.1 mm)

MATERIAL AND WEIGHT

Material: Kst / INOX / Alu

Weight: 2.9 kg

LOADS

Breaking load horizontal: 27 kN

Tightening torque for bolts and hex-nuts

M8: 17 Nm

Tightening torque for bolts M12: 40 Nm

APPLICABLE STANDARDS

DIN EN 50119

DIN EN 50124-1

DIN EN 50151

CEI / IEC 60060-1

FUNCTION

Insulator body for fastening to pipes, in medium to narrow bends. Continuously adjustable double suspension eye allowing the attachment of all type curve rail.

SPECIFICATIONS

Operating voltage: max. 1500 V DC

COMMENTS

The application in overhead contact lines requires a wide insulation of the support structure to the support bases.

Directly mountable to circular profiles of any material.

Optional: Exchanging the u-bolt allows mounting to pipes Ø45 – 80mm.

The suspension can be mounted to cross-spans or ceilings by exchanging the clamp.