

E2712-01

**SWITCH DRIVE ATTACHMENT TO WALL FOR MANUAL OPERATION LIFTING
75/120 MM AND MANUAL OPERATION LIFTING 120 MM WITH LOCKING**

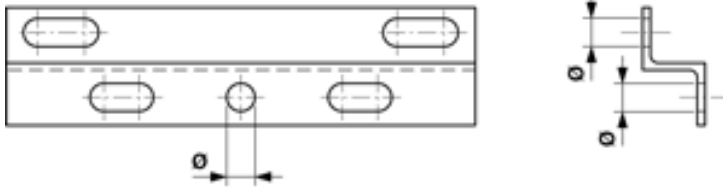

DIMENSIONS

Ø: 18 mm

MATERIAL AND WEIGHT

Material: STL HDG

COMMENTS

- 2 brackets are always needed for a switch drive
- Attachment material to wall on request